

Mamiya leaf

Leaf Credo Digital Back
with
Mamiya 645DF⁺ System

Quick Guide

Quick Guide

Contents

1. Contents of Kit	3
2. Overview.....	4
3. Before You Start	6
4. Mounting the Leaf Credo Back	12
5. Getting Started.....	14
6. Using the Soft Buttons.....	16
7. Navigating the Back Menu	17
8. Setting Up Digital Back	18
9. Taking a Shot.....	19
10. Browsing Images.....	20
11. Evaluating your Shot	22
12. Editing your Images.....	24
13. Changing the Focusing Screen.....	26
14. Custom Camera Functions	28
15. Installing software	30
Leaf Limited Warranty	31

This Quick Guide shows the basic operation of your new Leaf Credo digital back with Mamiya 645DF⁺ system. Download the User Guide for advanced operations of the camera, digital back and software.

1. Contents of Kit

- Leaf Credo digital back
- Dual charger for Leaf Credo battery
- 12 V Power adapter and regional adapters
- Two Li-Ion 7.2V 3400 mAh batteries
- USB 3.0 cable (3 m)
- FireWire 800-800 cable (4.5 m)
- Capture One Pro 8
- Neutral test patch
- LCC calibration plate
- Optical cleaning wipers
- Credo cleaning wipes
- Leaf Credo Quick Guide
- Mamiya focusing screen 44 x 33 mm (Credo 40 & 50 only)
- USB Drive

2. Overview

1. Eyepiece shutter lever
2. Hot shoe
3. Exposure mode dial
4. Mirror (do not touch)
5. Electronic contacts
6. Lens mount alignment mark
7. Depth of field preview button
8. Drive dial
9. Shutter release button
10. Front dial
11. Rear dial
12. Strap lug
13. Main LCD



1. Diopter adjustment dial
2. Strap lug
3. Synchro terminal
4. Electronic shutter release contact
5. Lens release button
6. Focus mode selector lever
7. AF lock button
8. Auto focus assist infrared light emission window/self timer lamp



1. Rubber eye piece
2. Digital Back
3. Self timer/interval button
4. Main LCD backlight button
5. Multiple exposure button/
Focus point selector button
6. Auto bracketing button
7. Set button/Flash auto adjustment select button/
Exposure compensation button
8. Auto exposure lock button
AEL Exposure metering button



3. Before You Start

1. Charging batteries

Li-Ion battery pack for camera

To charge your Mamiya 645DF⁺ Li-Ion battery pack:

1. Connect the charger to a power outlet using the included 12 V power supply with the appropriate international adapter.
2. Place the battery firmly in the charger.
When properly connected, the LED indicates the status of the battery:

LED Color	LED Status	Comment
Red	Steady	Charging
Green	Steady	Fully charged
Red	Flashing	Error / No connection

Charging is complete when the green LED is steady.



Battery for Credo digital back

To charge your Leaf Credo battery:

1. Connect the Credo digital back battery charger to a power outlet.
2. Insert the batteries in the charger and charge each battery (approximately 2.5 to 3 hours).

2. Inserting batteries

Li-Ion battery pack for camera

1. Ensure the drive dial is set to L (off).
2. Turn the camera upside down, lift the battery case lock lever and turn it counter clockwise.
3. Pull out the AA battery holder.

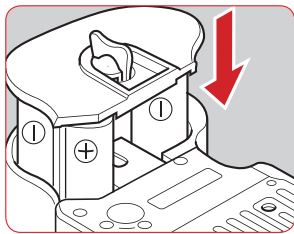
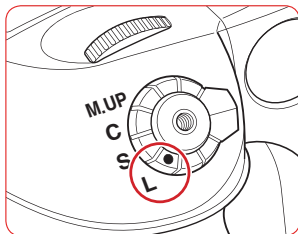

4. Insert a charged Li-Ion battery pack into the camera's battery compartment and lock it by turning the battery case lock lever clockwise.

Battery for Credo digital back

1. Open the battery compartment cover and slide the battery into the battery bay in the bottom of the digital back.
2. Close and lock the battery compartment cover.



3. Setting battery type

In order to utilize the Li-Ion battery in your 645DF/645DF+ camera, you need to set your camera's Custom Function 04 Battery Type to 2.

To set the battery type, you must initiate one of the Custom Function (CF) banks, then set the battery type.

Initiating CF — Bank A, B or C [00]

1. Turn on the camera body, and set the mode dial to CF.
2. Using the front dial, scroll to CF function 00.
3. Using the rear dial, select bank A, B or C.

In order to use Custom Function 04, you must initiate at least one of the banks.

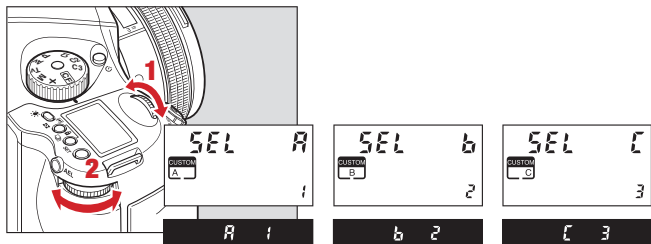

Setting Battery Type [04]

1. Using the front dial, scroll to Custom Function 04.
2. Using the rear dial, select 0, 1 or 2.
 - 0 = Standard AA alkaline batteries
 - 1 = AA NiMH / NiCD batteries
 - 2 = Li-Ion Rechargeable battery

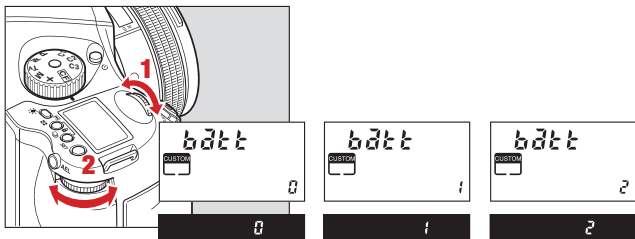

On Leaf Credo digital backs this custom function can be set from within the digital back menu system when the back is connected to the camera: Camera settings > 645DF > Active Custom Set > A > Setup Custom A > Battery type.

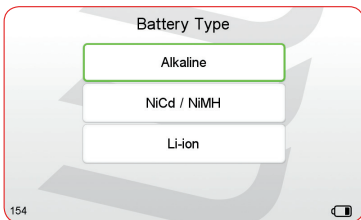

3. Attach and remove a lens

Remove the front body cap, just like you would remove a lens, by pushing the lens release button **A** backward and then turn the front body cap counter clockwise and lift out.

Line up the lens mount alignment mark **B** with mark **C** on the camera to fit the lens in place, then rotate it in the direction of the arrow until it clicks into place.

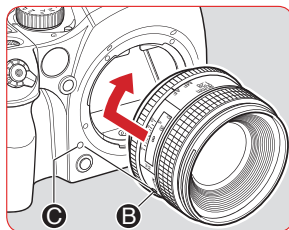
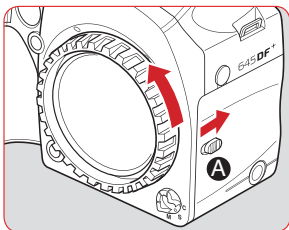

4. Mounting the Leaf Credo Back

1. Remove the back cover from the camera.



2. Unlock the back by sliding the back lock away from the camera.
3. While holding down the back release button, remove the sensor cover plate from the back.
4. Place the bottom part of the back in the lower locking mechanism on the back of the camera body.



5. While holding down the back release button, push the back and camera body together firmly.



6. Release the back release button.
7. Slide the back lock to the locked position (towards the camera).

Note: Your back should always be protected by its sensor cover plate when it is not attached to the camera.

5. Getting Started

1. Turn on the camera

Switch the drive dial to "S".

Choose your preferred exposure mode using the exposure mode dial.



2. Insert a formatted CF card

A CF card can be formatted in either your Credo back or computer.



3. Turn on the digital back*

Press and briefly hold the on/off button on the Leaf Credo back. The system is ready to shoot when you hear the beep and you see the home page on the screen.



* With more recent firmware version on the digital back, it will turn ON/ Off with the camera body.

6. Using the Soft Buttons

Home Button

Returns to the main menu screen

Browse Button

Tap takes you to browse view from any screen

Back Button

Takes you back to the previous screen

Dynamic Menu

Displays additional options if available for the screen being viewed



7. Navigating the Back Menu

Camera Settings:

- Format CF card
- Live View
- 645DF/Camera

White balance:

- Auto
- Daylight
- Tungsten
- Fluorescent
- Flash
- Custom WB



Settings:

- Digital back settings
- Brightness
- Power management
- Date/time
- Language
- Storage
- Firmware

ISO Selection

8. Setting Up the Digital Back

Configure the following:

- Interface language



- Date and Time

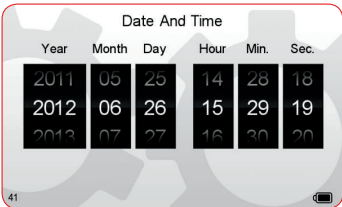

9. Taking a Shot

Press the release button to start shooting.



10. Browsing Images

- Tap browse soft button to access images.
- Swipe bottom to see other images.



- Single tap to select an image.
- Double tap on image to view in 100%.
- Zoom scaling from 6% to 400% by swiping on the right margin area.



- Pan across image using bottom or left area.

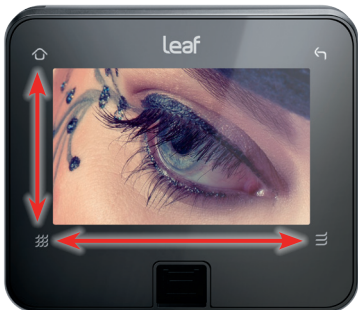

- Side zoom control.
- Tap screen to wake up back.

11. Evaluating your Shot

- Tap small histogram.



- View detailed histogram.

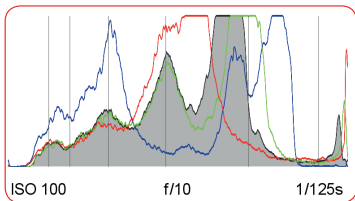

- Tap over-exposure warnings.
Tap Dynamic soft button for more options.



- Check sharpness with zoom.



- Set white balance:
 1. Tap on screen to access full-screen image.
 2. Tap Dynamic menu soft button.
 3. Tap WB icon.
 4. Use picker to select neutral balance.



- Tap Exposure information.



12. Editing your Images

- Browse your images.



- Delete an image by tapping the Dynamic button and tapping trash icon.

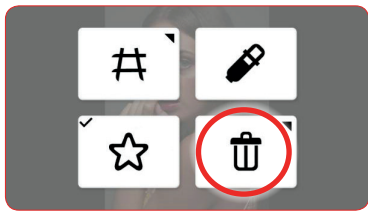

A long tap on a thumbnail enables multiple selection.

- Rate your images.
Tap Dynamic soft button for rating menu.



- Tap stars to rate images.

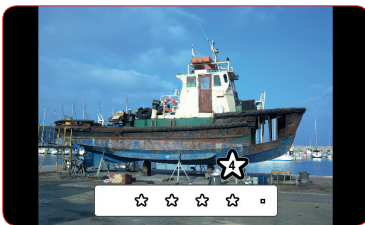

13. Changing the Focusing Screen

1. Remove the lens
2. Pull the focusing screen release lever **A** forward, as illustrated, with the tweezers to release the focusing screen.

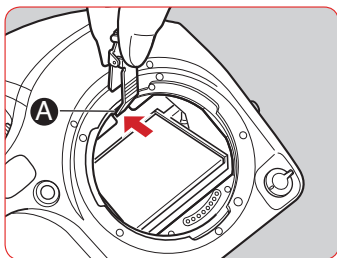

3. Remove the focusing screen from the focusing screen frame by grasping the tab on the edge of the screen with the tweezers as illustrated.

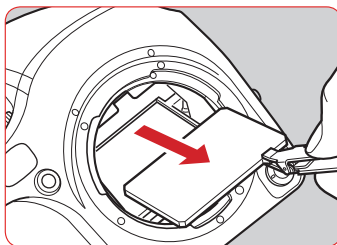

*** Do not touch the mirror or allow it to be damaged in any way.**

4. When installing the screen, pinch the protruding part of the screen using the screen holder, and put the screen on the screen frame.

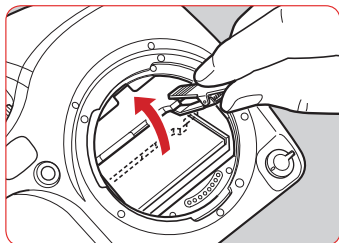

5. Push the screen frame up using the tweezers until hearing a clicking sound. The screen is now properly installed.
* **Never press down on other parts as this will affect the focus function.**

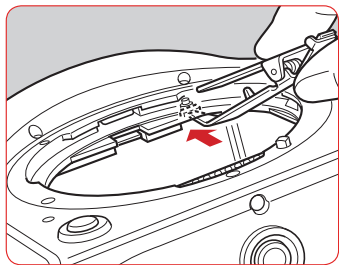

Caution

- Since the focusing screen's surfaces are soft and easily damaged, handle them carefully.
- Never touch the surface with bare fingers.
Should dust settle on it, merely blow it away by using a blower.
- If the focusing screen needs cleaning, send it to the nearest authorized Mamiya service center. Do not attempt to clean the surface of the focusing screen, as it is very delicate.

14. Custom Camera Functions

- C-00 – Select user configuration: A, B, C
- C-01 – TV/AV/Exp step: 1/3, 1/2 or 1 EV
- C-02 – Aperture setting after lens change
- C-03 – Time to sleep mode (def. 15 sec)
- C-04 – Battery type (Alkaline, NiMh/NiCD or Li-Ion)
- C-05 – Auto Bracketing steps (3, 5 or 7)
- C-06 – Front/Rear dial function in Manual mode
- C-07 – Disable rear dial in P mode
- C-08 – Dial function direction
- C-09 – AEL & AFL button exchange
- C-10 – Shutter half-press function
- C-11 – AEL function lock/unlock mode
- C-12 – AFL lock mode setting
- C-13 – One push function M-Mode
- C-14 – AF beam setting
- C-15 – Flash sync. timing
- C-16 – Beep
- C-17 – Choose shutter function (P, Av or Tv mode)
- C-18 – Shutter function in Manual mode
- C-19 – AF Speed
- C-20 – AF Fine Tune
- C-98 – Lens Firmware version
- C-99 – Camera body firmware version

Words and letters on the camera's LCD are abbreviated due to limitations of space and available letters

Display examples of the main LCD

<i>On</i>	→	ON
<i>OF</i>	→	OFF
<i>Err</i>	→	Error
<i>+</i>	→	+ (Plus)
<i>u</i>	→	Under
<i>o</i>	→	Over
<i>n</i>	→	Normal
<i>Loc</i>	→	Lock
<i>SELF</i>	→	Self Timer
<i>bulb</i>	→	bulb
<i>buSY</i>	→	Busy
<i>db</i>	→	Digital Back
<i>LS</i>	→	Lens Shutter
<i>CAP</i>	→	Capture
<i>rP</i>	→	Repeat
<i>TIME</i>	→	Time
<i>batt</i>	→	battery

Display examples in the custom function mode

<i>SEL</i>	→	Selection
<i>StEP</i>	→	Step
<i>IRIS</i>	→	Iris
<i>HOLD</i>	→	Hold
<i>batt</i>	→	battery
<i>ShotNo</i>	→	Shot No.
<i>dF</i>	→	Dial function
<i>d.AC</i>	→	Dial action
<i>d.di</i>	→	Dial direction
<i>AEFL</i>	→	AE, AF lock
<i>HALF</i>	→	Half press
<i>REL</i>	→	AE lock
<i>RFL</i>	→	AF lock
<i>OnEP</i>	→	One-push exposure
<i>AF.L</i>	→	AF assist light
<i>FLSY</i>	→	Flash sync
<i>bu</i>	→	Buzzer
<i>Sh.P</i>	→	Shutter in Program
<i>Sh</i>	→	Shutter in Manual
<i>RF.2</i>	→	AF second mode

15. Installing Software

Install Capture One

Capture One is supplied on a CD / USB drive or you can download it from <http://www.mamiyaleaf.com/downloads.asp>

Leaf Limited Warranty

Warranty Coverage

Leaf warrants the digital camera back against defects in materials and workmanship for a period of one (1) year from the date of original retail purchase. Should you discover a defect, Leaf will, as its option, repair or exchange the Leaf product at no charge to you provided that you notify Leaf during the warranty period.

Obtaining Warranty Service

In the event that you believe the Leaf product requires service, please call your Leaf product specialist first. Often a Leaf product specialist can resolve technical issues over the phone, thereby avoiding a return. If service is required, your Leaf product specialist will provide an approval for that action. To find your local Leaf representative go to: www.mamiyaleaf.com

Exclusions and Limitations

This warranty does not apply if the Leaf product has been damaged by accident, installation, shipment, abuse, misuse, misapplication, neglect, fire, water, lightning, or other acts of nature; by failure to follow supplied instructions; or by modification or repair by unauthorized personnel. Leaf shall not be liable for any indirect damages, including, without limitation, lost profits, damage to other property caused by any defect in the Leaf digital back, damages based upon inconvenience, loss of use of the Leaf digital back, loss of time, commercial use, incidental and/or consequential damages for the breach of any expressed or implied warranty, including damage to property and, to the extent permitted by law, damages for personal injury, even if Leaf has been advised of the possibility of such Damages.

The Leaf product may contain refurbished parts. Leaf warrants the refurbished parts in Leaf products for a period of one year from the date of original retail purchase.

THIS WARRANTY IS IN LIEU OF ALL WARRANTIES, WHETHER ORAL OR WRITTEN, EXPRESSED OR IMPLIED. ALL EXPRESSED OR IMPLIED WARRANTIES FOR THIS LEAF DIGITAL BACK, INCLUDING THE IMPLIED WARRANTIES OF MERCHANTABILITY AND FITNESS FOR PARTICULAR PURPOSE, ARE LIMITED TO THE WARRANTY PERIOD. NO WARRANTIES, EXPRESSED OR IMPLIED, WILL APPLY AFTER THE WARRANTY PERIOD.

Photos by Frank Doorhof (pages 20 and 21).

Photos by Lander Larrañaga (pages 20 and 24).

Photo by Leon Goldsmith (pages 22, 23 and 25).

Mamiya leaf

<http://www.mamiyaleaf.com>